

REV.	DESCRIPTION	DRAWN	DATE
1	INITIAL RELEASE	TIM	2019/08/08
2	ECR260417001	Fros	2026/04/17

SPECIFICATION:

1. ELECTRICAL
 - 1.1 Current Rating: 5A max.
 - 1.2 Voltage Rating: 20V max.
 - 1.3 Contact Resistance: 40mΩ
 - 1.4 Insulation Resistance: 100MΩ
 - 1.5 Dielectric Withstanding Voltage: 100VAC

2. MECHANICAL
 - 2.1 Durability: 10,000 cycles
 - 2.2 Insertion Force: 5 to 20N
 - 2.3 Extraction Force: 8 to 20N

3. ENVIRONMENTAL
 - 3.1 Operating temperature range: -40°C~+85°C

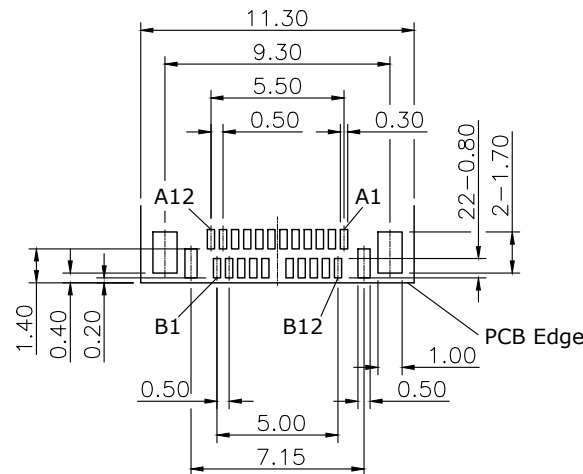
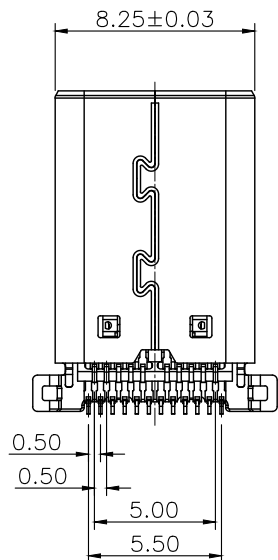
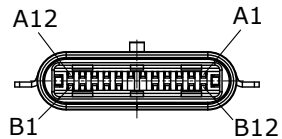
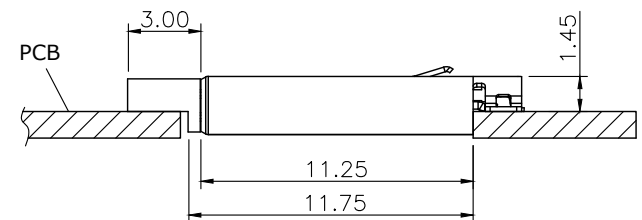

RECOMMENDED LAYOUT (TOP VIEW)
GENERAL TOLERANCE: ±0.05mm

6	Cap	Synthetic resin, Black
5	Latch	Stainless steel
4	Spring	Stainless steel
3	Shell	Stainless steel, 50u" Nickel
2	Contact	Copper alloy, under-plated: 50u" Nickel
		Contact area: 30u"Gold
		Solder tails area: 80u"~120u" Tin
1	Housing	Thermoplastic, Black
NO.	PART NAME	DESCRIPTION

UNLESS OTHERWISE SPECIFIED TOLERANCE

UNIT:	DECIMAL	LINEAR	ANGLES
mm	X.	±0.50	±5°
	X.X	±0.25	±3°
	X.XX	±0.12	±1°



WWW.ATTEND.COM.TW

DRAWN	Tim	2019/08/08	DRAWN NAME:	USB Type C Plug	
CHECKED	Fors	2019/08/08		Sink Type, SMD Type, 30u"	
APPROVED	Ken	2019/08/08	PRODUCT NO.	217A-BG04	
SCALE	3.2	SHEET	1/1	SIZE	A4
FILE NAME	217A-BG04_B_2				